



STERLING

EXCELLENCE ADRIA



EXCELLENCE ADRIA

Length: 53.28 metres (174' 10")

Beam: 8.60 metres (28' 3")

Draft: 3.5 metres (11' 6")

Number of Guests: 20

Number of Crew: 12

Built: 2020

Refit: 2024

Naval Architect: Ivica Sarun of Nauta d.o.o.

Hull Construction: Steel

Hull Configuration: Displacement

WiFi connection on board, Stabilisers underway, Gym/exercise equipment, Deck Jacuzzi, Air conditioning

The 53.3m EXCELLENCE ADRIA was launched in 2020 and is undergoing an extensive refit over the winter of 2023/2024. This stunning & modern yacht offers guests luxurious accommodation and facilities over 4 decks and is perfect for a large group as she can sleep up to 20 in 10 guest staterooms and has a capacity to day cruise with 36 guests onboard. She is packed with amenities that will give guests the most pleasurable experience cruising the Croatian waters and the experienced crew will make sure you will always receive the highest level of service.

The thoughtful furnishing and attention to detail creates an

intimate environment, despite the yacht's vast spacious interior areas. It's design focuses on delivering the ultimate pleasure for her guests with 4 x master staterooms – all with his and hers en suite bathrooms, with a further 4 double staterooms with king size beds and 2 twin staterooms. All staterooms come with en suites and smart TVs including satellite TV.

The impressive main saloon has two dining tables able to host 24 guests with an informal lounge area where guests can relax with a cocktail from the bar. If guests wish to dine outside to enjoy the beautiful surroundings, there are two dining tables on the upper deck, also seating 24 guests. On the sundeck there is also a BBQ area and a pizza oven, along with an outdoor cinema, making it the perfect spot to watch sports or a film, whilst enjoying pizzas and BBQ in a more relaxed setting. On the sundeck you will also find the Jacuzzi and many sun loungers, where guests can relax and soak up the sun.

For those more active, there is a large outdoor gym on the top deck featuring a treadmill and exercise bike along with a TRX, pull-up bar, free weights and yoga mats. There is an 8.7m Marine Mito chase boat as well as a 5m Brig tender that can comfortably take guests out to explore the stunning surroundings or do water sports. There is a full list of water toys and an extendable swim platform with an inflatable

Key Features

- 1** 4 Master staterooms with his and hers en suites, plus a further 4 king double and 2 twin staterooms
- 2** Indoor and outdoor cinema
- 3** Full SPA & Wellness centre
- 4** Dining tables for 24 guests in the main saloon as well as on upper deck
- 5** BBQ area along with pizza oven on the sundeck
- 6** Jacuzzi on the sundeck
- 7** Gym on top deck including exercise bike & treadmill
- 8** 8.7m Marine Mito chase boat plus 5m Brig tender and full list of toys including inflatable pool (netted)



View from above



Aft view



Sun deck



Sun deck aft



Sundeck seating area



Sundeck



Sundeck aft



Sundeck aft



Upper deck aft



Sundeck outdoor cinema at night



Main salon



Main salon



Fine dining in main salon



Lounge area in main salon



Lounge area in main salon



Main salon



Main salon



Main salon wine cellar



Cinema on lower deck



Cinema on lower deck



Master stateroom 1



Master stateroom 1



Master stateroom 1



Master stateroom 1



Master stateroom 1



Master stateroom 1



Master stateroom 2



Master stateroom 2 - Main deck



Master stateroom 2 - Main deck



Master stateroom 2 - Main deck



Master stateroom 2 - Main deck



Master stateroom 2 lounge area - Main deck



Master stateroom 2 with office space - Main deck



Master stateroom 3 - Main deck



Master stateroom 3 with lounge and office space - Main deck



Master stateroom 3 - Main deck



Master stateroom 3 - Main deck



Master stateroom 3 with lounge and office space - Main deck



Master stateroom 3 lounge area - Main deck



Master stateroom 3 with office space - Main deck



Master stateroom 4 - Main deck



Master stateroom 4 - Main deck



Master stateroom 4 - Main deck



Master stateroom 4 - Main deck



Master stateroom 4 - Main deck



Master stateroom 4 - Main deck



Master stateroom 4 - Main deck



Master stateroom 4 - Main deck



Double stateroom

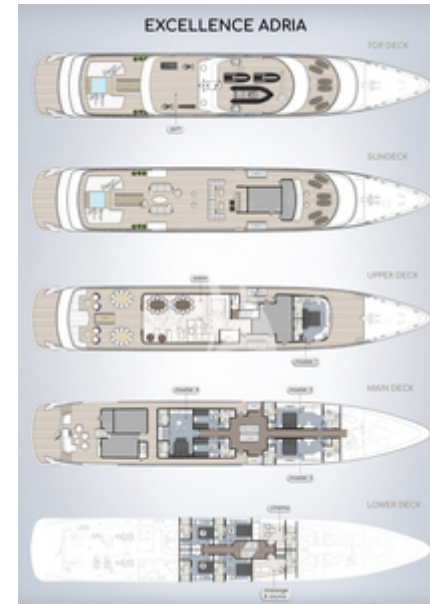

Layout

SPECIFICATIONS

ACCOMMODATION

Number of guests: 20

Number of cabins: 10

Cabin configuration: 8 Double Cabins, 2 Twin Cabins

Bed configuration: 8 King Beds, 4 Single Beds

EQUIPMENT

Engines: 2 x Volvo 500hp engines 1 x Cummins 152kw,
2 x Iveco 50kw, 1x Yanmar 34kw generators

Cruising Speed: 9 knots

Fuel Consumption: 100 Litres/Hr

WATERSPORTS

Tender + Toys: Tenders:

8.7m MV Marine Mito 29T tender with 2 x Mercury
200hp engines

5m Brig tender with Yamaha 60hp

Toys:

2 x Seadoo jetskis

2 x Seabob F5 S

E foil

Electric paddleboard

6 x SUP

2 x inflatable kayaks

2 x water skis (1 x adult / 1 x junior)

2 x wakeboards (1 x adult / 1 x junior)

Ringo ride

Banana ride

20 x snorkelling equipment

10 x Fishing equipment

Beach set up

6 x Floating mattress

Extendable platform

Inflatable sea pool (netted)

LAYOUT

EXCELLENCE ADRIA

TOP DECK

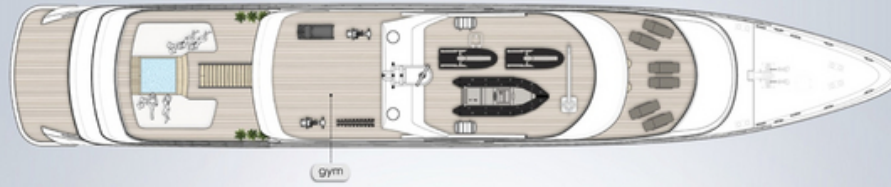

SUNDECK



UPPER DECK



MAIN DECK



LOWER DECK

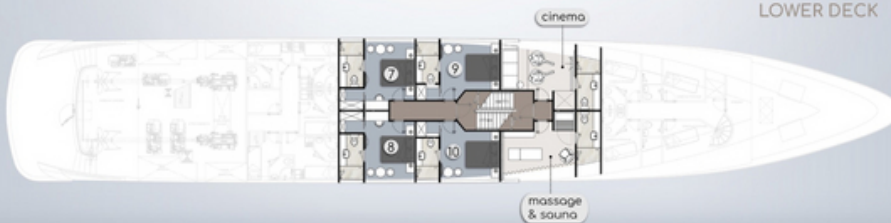



STERLING

Sterling Yachting

Duntshill Road

United Kingdom , London, SW18 4QL

Tel: 0044 7787 518894

charter@sterlingyachting.com

www.sterlingyachting.com

Disclaimer

This document is not contractual. All specifications are given in good faith and offered for informational purposes only. The publisher and company do not warrant or assume any legal liability or responsibility for the accuracy, completeness, or usefulness of any information and/or images displayed. Yacht inventory, specifications and charter prices are subject to change without prior notice. None of the text and/or images used in this brochure may be reproduced without written consent from the publisher.